

Temperature Blending Valve (Manually Adjustable)

In public areas using a TMV2/3 Thermostatic Mixing Valve (set at 40°C *approx.*) is considered suitable to provide safe pre-mixed warm water to an appliance (tap, shower etc). The temperature is not adjustable by the public, only by the building manager.

If however you want to offer your customer the ability to manually adjust the temperature of the water between say 40°C and cold, then this robust & tamper proof Temperature Blending Valve should be used (NB: We would strongly recommend that you also use a Thermostatic Mixing Valve to safely control the maximum water temperature into the Temperature Blending Valve). We can also supply TMV3 Mixing Valves.

Typical Installation: Plumbing guidelines for Shower using Temperature Blending Valve

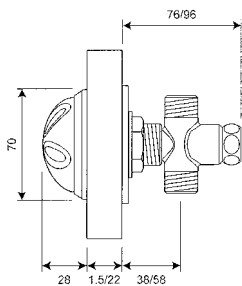
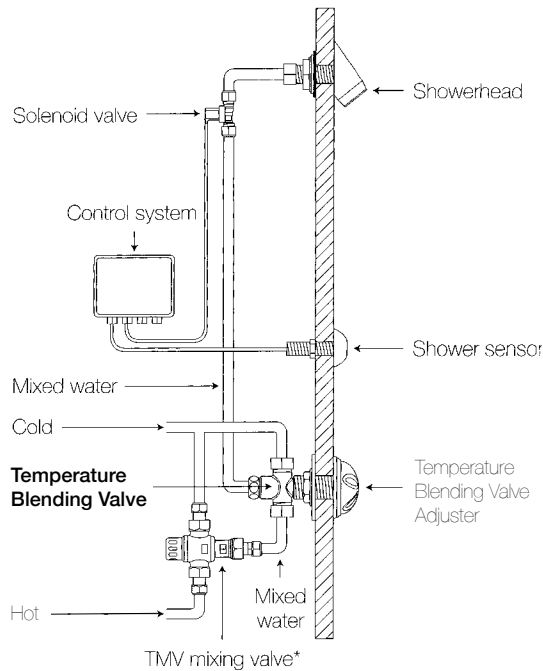

Order Code
TBV/ADJ/22

Application

For 1.5mm – 22mm wall thickness.
Fixing ¾" BSP. (Ø28mm drill hole)

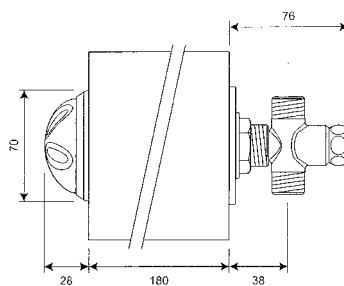

Order Code
TBV/ADJ/180

Application

For up to 180mm wall thickness.
Fixing ¾" BSP. (Ø28mm drill hole)

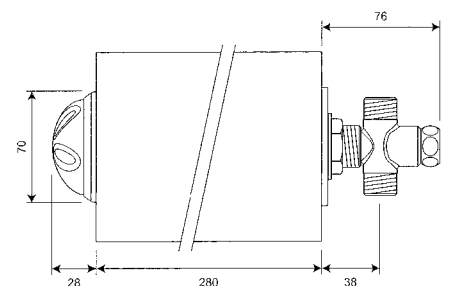

Order Code
TBV/ADJ/280

Application

For up to 280mm wall thickness.
Fixing ¾" BSP. (Ø28mm drill hole)



ROBERT PEARSON & COMPANY LTD

Post Office House, Post Office Lane
Stockton, Warminster
Wiltshire BA12 0SE

Telephone: (01985) 850954

Facsimile: (01985) 850112

E-Mail: sales@robertpearson.co.uk

Website: www.robertpearson.co.uk